



TECHNOLOGY DATA SHEET & SPECIFICATIONS

MODEL: 3528Y1C-KHA-C

Features

- PLCC-2 package.
- White package.
- Wide viewing angle.
- Computable with automatic placement equipment.
- Pb-free



Descriptions

• The 3528 series has wide viewing angle and optimized light coupling by inter reflector. This feature makes TOP LED ideal for light pipe application. The low current requirement makes this device ideal for portable equipment or any other application where power is at a premium.

Usage Notes:

- Surge will damage the LED
- When using LED, it must use a protective resistor in series with DC current about 20mA

Applications

- Automotive: backlighting in dashboard and switch.
- Telecommunication: indicator and backlighting in telephone and fax.
- Flat backlight for LCD, switch and symbol.
- Light pipe application.
- General use.



TECHNOLOGY DATA SHEET & SPECIFICATIONS

MODEL: 3528Y1C-KHA-C

Device Selection Guide

LED Part No.	Chip		Lens Color
	Material	Emitted Color	
3528Y1C-KHA-C	AlGaInP	Yellow	Water clear

Package Dimensions

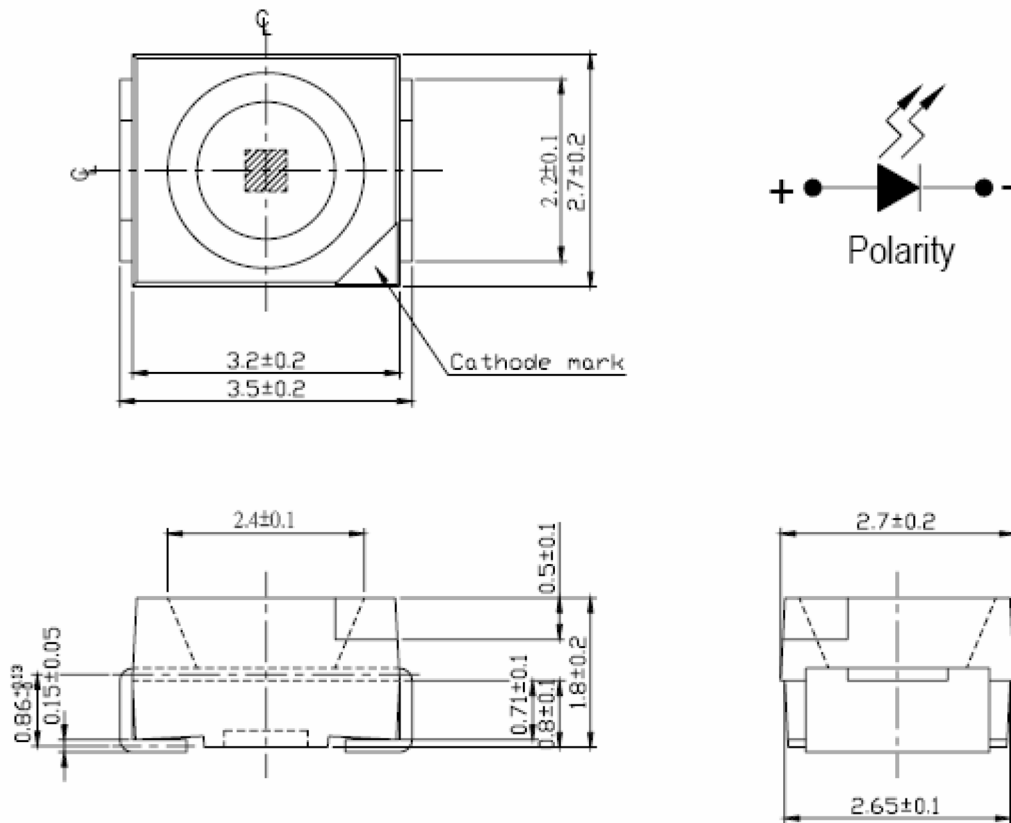

Notes:

- Other dimensions are in millimeters, tolerance is 0.25mm except being specified.
- Protruded resin under flange is 1.5mm Max LED.
- Bare copper alloy is exposed at tie-bar portion after cutting.



TECHNOLOGY DATA SHEET & SPECIFICATIONS

MODEL: 3528Y1C-KHA-C

Absolute Maximum Rating (T_a=25°C)

Parameter	Symbol	Absolute Maximum Rating	Unit
Peak Forward Current (Duty 1/10 @1KHz)	I _F	60	mA
Forward Current	I _{FM}	25	mA
Reverse Voltage	V _R	5	V
Power Dissipation	P _D	60	mW
Operating Temperature	T _{opr}	-40~+80	°C
Storage Temperature	T _{stg}	-40~+100	°C
Soldering Temperature	T _{sol}	Reflow Soldering : 260 °C for 10 sec. Hand Soldering : 350 °C for 3 sec.	



TECHNOLOGY DATA SHEET & SPECIFICATIONS

MODEL: 3528Y1C-KHA-C

Electro-Optical Characteristics (T_a=25°C)

Parameter	Symbol	Min.	Typ.	Max.	Unit	Test Condition
Luminous Intensity	I _v	300	---	450	mcd	IF=20mA (Note1)
Viewing Angle	2θ _{1/2}	---	120	---	Deg	(Note 2)
Peak Emission Wavelength	λ _p	580	---	595	nm	IF=20mA
Spectral Line Half-Width	Δλ	---	15	---	nm	IF=20mA
Forward Voltage	V _F	1.9	---	2.4	V	IF=20mA
Reverse Current	I _R	---	---	10	μA	VR=5V

Note:

1. Luminous intensity is measured with a light sensor and filter combination that approximates the CIE eye-response curve.
2. θ_{1/2} is the off-axis angle at which the luminous intensity is half the axial luminous intensity.



TECHNOLOGY DATA SHEET & SPECIFICATIONS

MODEL: 3528Y1C-KHA-C

Reliability Test Items And Conditions

No	Item	Test Condition	Sample Number	Criteria for Judging	Ac/Re
1	Solder ability	T=235±5℃ T=5sec.	15	Good wetting	0/1
2	Soldering heat	T=260±5℃ T=10sec.	15	IV≥LSL* VF≤USL* IR≤USL	0/1
3	Rapid change of temperature followed by: damp heat, cyclic	L:-40℃ 10min (2~3) min H:+100℃ 10min 5cycle T= (25~55) °C RH: (90~95) % 2cycle 48h recovery time 2h	11	IV≥LSL VF≤USL IR≤USL	0/1
4	Damp heat, cyclic	T=(25~55)℃ RH= (90~95) % 6 cycle 144h recovery time 2h	11	IV≥0.7LSL VF≤1.1USL IR≤2USL	0/1
5	Electrical endurance	I _F =30mA T=1000h	22	IV≥0.7LSL VF≤1.1USL IR≤2USL	0/1
6	Storage at high temperature	T _{stg} =100±2℃ t=1000h	15	IV≥LSL VF≤USL IR≤USL	0/1
7	Terminal strength	Tensile: W=5N t= 30s Bending: W=2.5N 2times	15	No damage	0/1

*U.S.L.: Upper Standard Level

* L.S.L.: Lower Standard Level



TECHNOLOGY DATA SHEET & SPECIFICATIONS

MODEL: 3528Y1C-KHA-C

APPLICATION NOTES:

1)Soldering:

① Manual soldering by soldering iron:

The use of a soldering iron of less than 25W is recommended and the temperature of the iron must be kept at no higher than 300°C.

② Reflow soldering:

a. The temperature profile as shown in Fig.3 is recommended for soldering SMD LED by the reflow furnace.

b. Care must be taken that the products be handled after their temperature has dropped down to the normal room temperature after soldering.

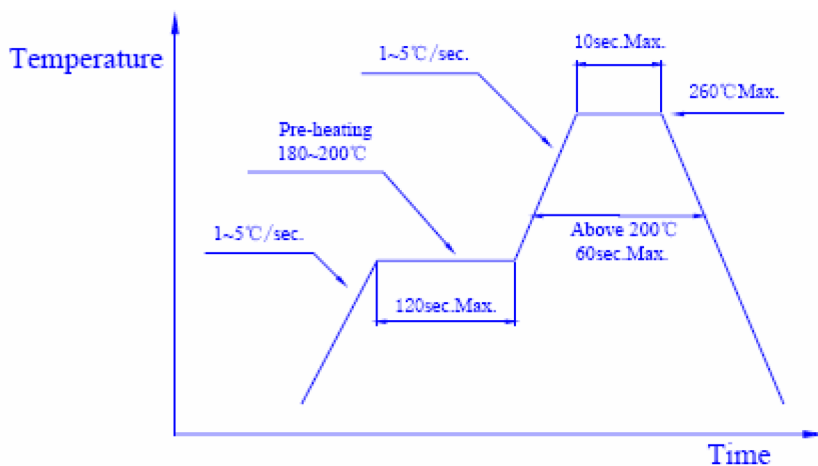

Fig.3

2)Post solder cleaning:

When cleaning after soldering is needed, the following conditions must be adhered to.



HUIYUAN OPTO-ELECTRONIC CO.,LTD

TECHNOLOGY DATA SHEET & SPECIFICATIONS

MODEL: 3528Y1C-KHA-C

- ① Cleaning solvents: Freon TF or equivalent or alcohol.
 - ② Temperature: 50°C Max. for 30 seconds or 30°C Max. for 3 minutes
 - ③ Ultrasonic: 300W Max.
- 3) OTHERS:
- a. Care must be taken not to cause stress to the epoxy resin portion of SMD LED while it is exposed to the high temperature.
 - b. Care must be taken not to rub the epoxy resin portion of SMD LED with a hard or sharp edged article such as the sand blast and the metal hook as the epoxy resin is rather soft and liable to be damaged.